

Sluitkomhoogtes

Benodigheden deurkozijn

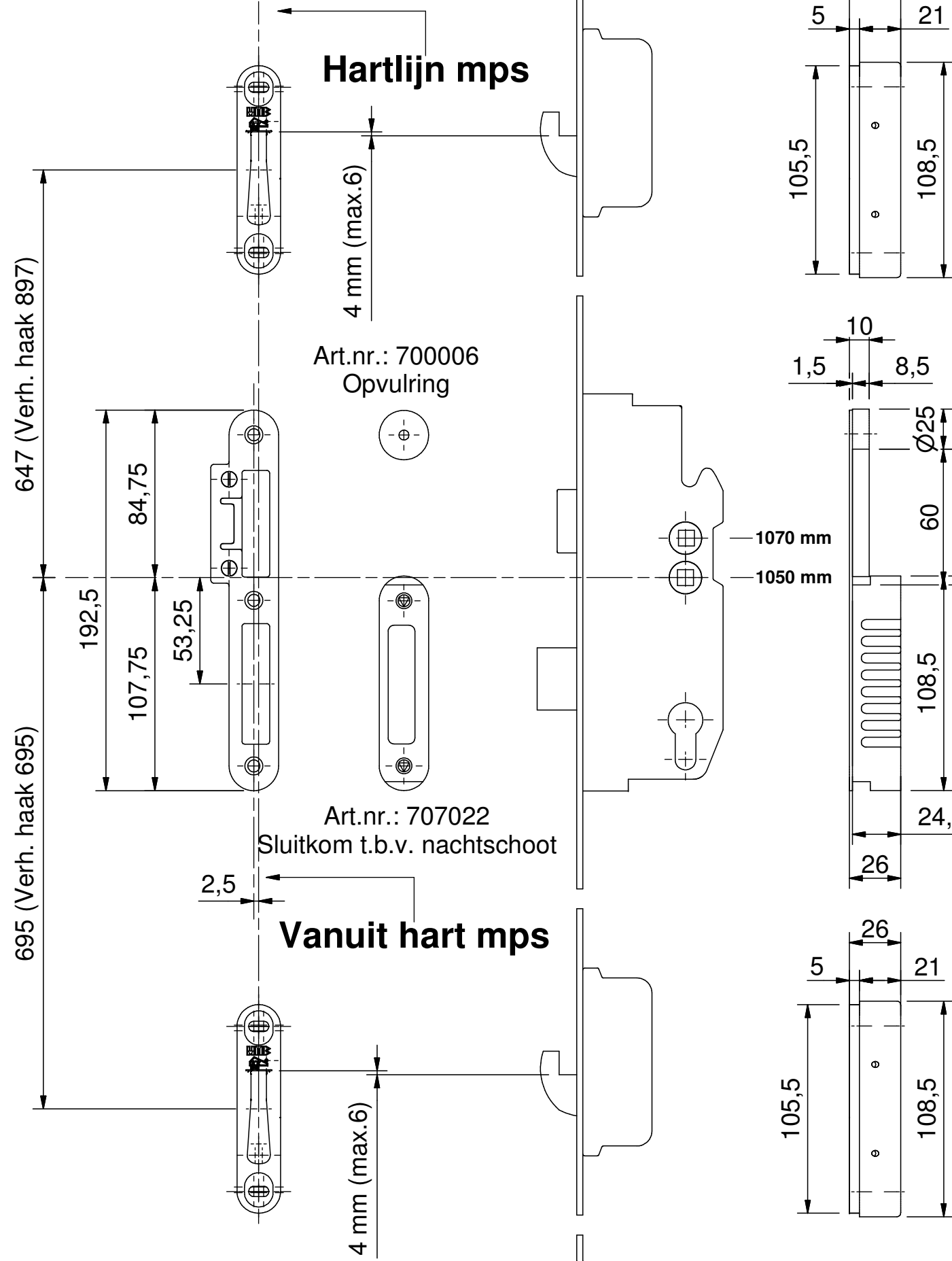

Advies

Gebruik schroeven 4.0 x 40 mm die goedgekeurd zijn door SKH.

De nastelbare sluitkom kan, voor de haakschoot van de meerpuntssluiting zowel onder als boven te gebruiken.

Let op: maten controleren in het werk!

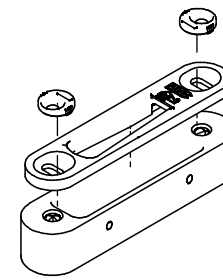

Art.nr.: 706300
Nastelbare sluitkom
(t.b.v. haakschoot)

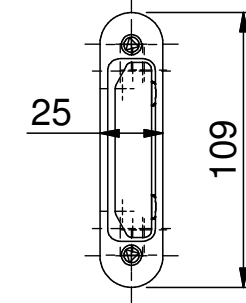

Art.nr.: 707023
Sluitkom

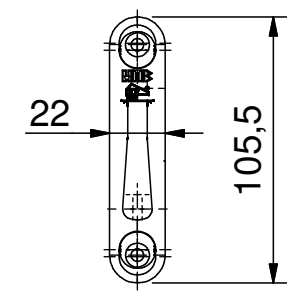

Art.nr.: 600357
Haakschootsluitplaat
(inclusief 2 excenters)

Overzicht Sluitplaten

A = 706380	B = 706390	C = 706400	D = 706410
Korte lip	Korte lip	Lange lip	Lange lip
Din links	Din rechts	Din links	Din rechts

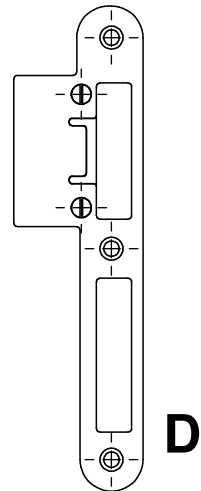
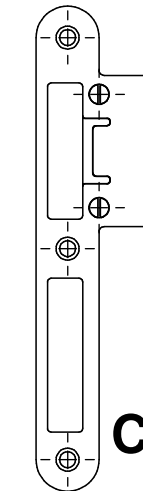
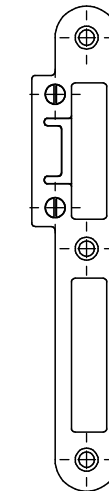
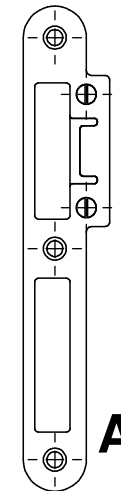

Threatment		Units	MM	Roughness	Unspecified tolerances	According NEN-ISO 1101
Aftertreatment		Not on scale bases		25	Dim ± 0,1	Angle ± 0,1°
Layer thickness		Reference		(25)	√ 3.2	
Description: Sluitkomhoogtes				Scale	Engineer: Ruben Borst	
Project: Benodigheden deurkozijn					Date: 8-9-2009	
Postbus 151 3400 AD IJSSSELSTEIN, HOLLAND TELEPHONE : 0031 - (0)30 - 6877940 FAX : 0031 - (0)30 - 6875688 E-MAIL : HMB@HMBPROFITTOOLS.NL				Projection	Revision	Project number:
					00	
THIS DRAWING REMAINS PROPERTY OF HMB PROFIT TOOLS AND MAY NOT BE COPIED WITHOUT OUR WRITTEN CONSENT.				A3	Drawing number	
					20091010	